

vtech[®]

User's Manual

Count 'n Go™ Snail



© 2002 VTech
Printed in China
91-01501-008 (美)

Dear Parent:

At VTECH® we know that a child has the ability to do great things. That's why all of our electronic learning products are uniquely designed to develop a child's mind and allow them to learn to the best of their ability. Whether it's introducing numbers and letters, identifying colors and shapes, or stimulating senses with lights and music, all VTECH® infant and toddler learning products encourage your child's natural growth and discovery skills. When it comes to providing electronic learning products that enlighten, entertain and develop minds, at VTECH® we see the potential in every child.

INTRODUCTION

Thank you for purchasing the **VTech® Count 'n Go™ Snail** learning toy! This product is one of a family of high quality electronic learning toys. We at **VTech®** are committed to providing the best possible products to entertain and educate your child. Should you have any questions or concerns, please call our Consumer Services Department at 1-800-521-2010 in the U.S. or 1-800-267-7377 in Canada.

The **VTech® Count 'n Go™ Snail** is a colorful push toy for toddlers 6 months and up. With the press of a button this magical snail comes to life. Watch it roll, watch it spin and watch it flash! Cute bug graphics on the shells introduce numbers, feeling words and insect names along with fun sound effects and melodies.

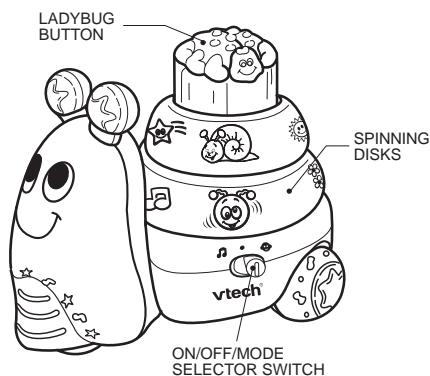

INCLUDED IN THIS PACKAGE

1. One **VTech® Count 'n Go™ Snail** learning toy
2. One instruction manual

2

WARNING: All packing materials, such as tape, plastic sheets, wire ties and tags are not part of this toy, and should be discarded for your child's safety.

BATTERY INSTALLATION

1. Make sure the unit is turned **OFF**.
2. Locate the battery cover on the bottom of the unit. Use a coin or screwdriver to loosen the screw.
3. Install 3 new AA batteries following the diagram inside the battery box. (The use of new alkaline batteries is recommended for maximum performance.)
4. Replace the battery cover and tighten the screw to secure the battery cover.

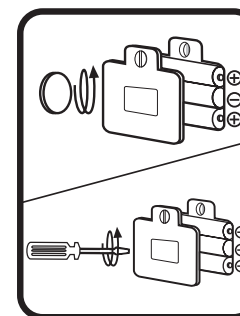

BATTERY NOTICE

- Install batteries correctly observing the polarity (+, -) signs to avoid leakage.
- Do not mix old and new batteries.
- Do not use batteries of different types.
- Remove batteries from the equipment when the unit will not be used for an extended period of time.
- Do not dispose of batteries in fire.
- Do not attempt to recharge ordinary batteries.
- The supply terminals are not to be short-circuited.

WE DO NOT RECOMMEND THE USE OF RECHARGEABLE BATTERIES.

3

NOTE: If for any reason the program/activity stops working, please follow these steps:

1. Turn the unit **OFF**.
2. Interrupt the power supply by removing the batteries.
3. Let the unit stand for a few minutes, then replace the batteries.
4. Turn the unit **ON**. The unit should now be ready to play again.

If the problem persists, please call our Consumer Services Department at 1-800-521-2010 in the U.S. or 1-800-267-7377 in Canada, and a service representative will be happy to help you.

TO BEGIN PLAY

1. To turn the unit **ON**, slide the **ON/OFF/MODE SELECTOR SWITCH** to the **TALKING MODE** (☺) or the **MELODY MODE** (🎵) position.



2. To adjust the volume, slide the **VOLUME CONTROL SWITCH** located on the bottom of the unit to the **LOW VOLUME** position (🔊) or the **HIGH VOLUME** position (🔊).

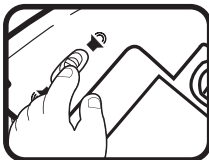

3. To turn the unit **OFF**, slide the **ON/OFF/MODE SELECTOR SWITCH** to the **OFF** (●) position.



Note: For the best movement, please use on a hard and flat surface.

Note: To preserve battery life, the VTech® Count 'n Go™ Snail learning toy will automatically power-down after several minutes without input. Press the button or turn the disks to turn the unit on again.

ACTIVITIES

A. TALKING MODE

1. Slide the **ON/OFF/MODE SELECTOR SWITCH** to the **TALKING MODE** (☺) position. You will hear "I'm a silly snail" and a giggle sound effect. The lights will flash randomly with the sound.



2. Press the **LADYBUG** button on the snail's back or turn the two spinning disks to line up two images. You will hear a random phrase, sound effect or short tune. The lights will flash randomly with the sounds, then the snail will run forward and the two disks will spin.

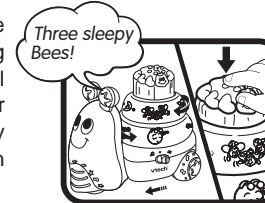

B. MELODY MODE

1. Slide the **ON/OFF/MODE SELECTOR SWITCH** to the **MELODY MODE** (🎵) position. You will hear "I'm a silly snail" followed by a short tune. The lights will flash randomly with the sounds.



2. Press the **LADYBUG** button on the snail's back or turn the two spinning disks to line up two images. You will hear a sound effect followed by a pre-programmed melody. The lights will flash randomly with the sounds, then the snail will run forward and the two disks will spin.

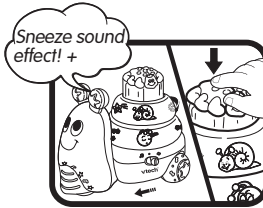

PRE-PROGRAMMED MELODIES

- | | |
|--------------------------|--------------------------|
| 1. Sur Le pont d'Avignon | 2. On Top of Old Smoky |
| 3. Ring Around A Rosy | 4. Teddy Bears' Picnic |
| 5. Sailing, Sailing | 6. My Bonnie |
| 7. Billy Boy | 8. Bicycle Built for Two |
| 9. Shoo Fly | 10. Jolly Good Fellow |
| 11. Good Night, Ladies | 12. Old Dan Tucker |

CARE AND MAINTENANCE

1. Keep the unit clean by wiping it with a slightly damp cloth.
2. Keep the unit away from direct sunlight and heat source.
3. Remove the batteries when the unit is not in use for an extended period of time.
4. Do not drop the unit on hard surfaces and do not expose the electronic core part to moisture or water.

IMPORTANT NOTE

Creating and developing toddler products is accompanied by a responsibility that we at **VTech®** take very seriously. We make every effort to ensure the accuracy of the information, which forms the value of our products. However, errors can sometimes occur. It is important for you to know that we stand behind our products and encourage you to call our Consumer Services Department at 1-800-521-2010 in the U.S. or 1-800-267-7377 in Canada with any problems and/or suggestions that you might have. Our service representative will be happy to help you.

NOTE:

This equipment generates and uses radio frequency energy and if not installed and used properly, that is, in strict accordance with the manufacturer's instructions, it may cause interference to radio and television reception. It has been type tested and found to comply within the limits for a Class B computing device in accordance with the specifications in Sub-part J of Part 15 FCC Rules, which are designed to provide reasonable protection against such interference in a residential installation. However, there is no guarantee that interference will not occur in a particular installation. If this equipment does cause interference with radio or television reception, which can be determined by turning the equipment off and on, the user is encouraged to try to correct the interference by one or more of the following measure:

- reorient the receiving antenna
- relocate this product with respect to the receiver
- move this product away from the receiver